

Department of Engineering
Tim Bryan, P.E., PTOE, County Engineer

3137 South Liberty Street, Canton, MS 39046
Office (601) 855-5582 FAX (601) 859-5857

MEMORANDUM

May 26, 2026

To: Casey Brannon, Supervisor, District I
Trey Baxter, Supervisor, District II
Gerald Steen, Supervisor, District III
Karl Banks, Supervisor, District IV
Paul Griffin, Supervisor, District V

From: Tim Bryan, P.E., PTOE
County Engineer

Re: Comcast Utility Permit
County Road Name, Old Maple Cove

The Engineering Department recommends approval for Comcast to bore and install 1-2" HDPE conduit .625 coax. The project begins with the existing ped -32.524486, -90.134859 to bore a total of 3378' into new phase of subdivision and install new peds within the right-of-way of the county road names listed below.

- Old Maple Cove
- Lewis Farms Drive
- Orchardview Cove
- Berryville Court.



PERMIT APPLICATION FOR THE CONSTRUCTION OR ADJUSTMENT OF A UTILITY WITHIN COUNTY ROAD RIGHT-OF-WAY

Utility Information: Utility Name: COMCAST CABLE COMMUNICATIONS MANAGEMENT, LLC ___
Address: 5720 ASHEVILLE HWY City/State/Zip: KNOXVILLE, TN 37922
Contact Person: LINDA TAIBL Contact's Phone: 404-427-1220

Project Information: County Road Name: OLD MAPLE COVE
(If located within more than one road right-of-way, use Appendix 1 for additional descriptions)

Beginning Location: 32.524486,-90.134859 _____ Ending Location: 32.525542,-90.138910
Length of Project: 3378' Section: 19 Township: 8N Range: 2E

Description of Work:

COMCAST PROPOSES TO BORE & INSTALL 1-2" HDPE CONDUIT .625 COAX. PROJECT BEGINS FROM EXISTING PED- 32.524486,-90.134859. BORE A TOTAL OF 3378' INTO NEW PHASE OF SUBDIVISION END INSTALL NEW PEDS ALONG OLD MAPLE COVE, LEWIS FARMS DR, ORCHARDVIEW COVE AND BERRYVILLE COURT. TOTAL FOOTAGE: 3378'. SEE ATTACHED PRINTS FOR EXACT LOCATIONS.

Check Box if Appendix 1 is to be included as a part of this Application

Whereas the above stated Utility makes application to the **Madison County Board of Supervisors** for a Construction Permit. Attached hereto are drawings and plans for the construction of the above facilities located within Madison County owned public rights-of-way. Once stamped by the Madison County Engineering Department, these plans shall not be changed or altered without written approval of the County Engineer, or his representative. A copy of the approved permit and plans shall be on-site at all times during construction.

The Applicant Utility shall comply with all policies, procedures and construction practices as outlined in *A Policy for The Accommodation of Utility Facilities within the Right-of-Way of all Public County Roads* (hereinafter referred to as the "Policy"), as adopted on November 1, 2005, by the **Madison County Board of Supervisors**, and which is hereby made a part of this Application Agreement.

If facilities are to be located within the Rights-of-Way of the County-Federal or State Aid System, Applicant Utility also agrees to comply with applicable provisions of *S.O.P. No. SA II-2-8, Accommodation of Utilities on Rights-of-Way*, issued by the State Aid Engineer and dated July 1, 2005.

The Applicant Utility understands and agrees that, except as herein granted, no right, title, claim, or easement to said road right-of-way is granted by the issuance of this permit. If this Utility is listed in the general provisions of the Policy, it will be adjusted to comply with same without cost to the County, unless the variance from the Policy has been approved by the granting of the Permit pursuant to this Application.

The Applicant Utility further understands that the Utility's engineering, plant, or other personnel will be responsible for the staking and construction supervision of the work set out above and as shown on the attached plans. If work impacts traffic in any way, the appropriate traffic control shall be installed per the *Manual of Uniform Traffic Control Devices*, Latest Edition.

The Applicant Utility understands that the County Engineer, or his representative, may issue a Stop Work Order at any time if it is deemed that site conditions are not suitable for construction or if any of the requirements of this permit are not being met.

Many County Roads have variable Rights-of-Way and/or no Right-of-Way at all and are maintained under a Prescriptive Easement. It is the sole responsibility of the Applicant Utility to verify the existence and limits of public rights-of-way. If none exists, it is the responsibility of the Applicant Utility to acquire an easement for their Facilities from the applicable property owner(s). Madison County in no way verifies the limits of Right-of-Way as shown on the permit application.

The Applicant Utility shall be responsible for all future maintenance and repair of the facilities installed under this permit. The Applicant Utility shall make future adjustments to, or relocate, the facilities located within road or highway right-of-way when

required for road or highway widening or other road or highway construction at no cost to Madison County. The Applicant Utility shall relocate said utilities within sixty (60) days of notification by County by registered mail, return receipt requested, unless otherwise designated by the County Engineer. Further, any maintenance, repair, or construction shall be done in such a manner as to occasion no unreasonable interference with the normal flow and safety to traffic and at the expense of the utility company. When reasonable care has been taken to locate said utility facilities within the right-of-way, the Applicant Utility understands that any damages caused by routine maintenance and construction by County forces shall be borne by the Applicant Utility.

The Applicant Utility further agrees to indemnify and hold Madison County harmless for any and all claims, accidents, damages, liabilities and expenses occasioned wholly, or in part, by any act or omission of applicant, its agents or employees. In case County shall, without fault on its own part, be made a party to any litigation commenced by or against applicant, then applicant shall protect and hold County harmless, and shall pay all costs, expenses and reasonable attorney's fees incurred or paid by County in connection with said litigation.

All underground facilities shall be installed at a depth equal to or greater than 48" below the lowest adjacent grade.

All pipes carrying liquid shall be encased under County maintained roads.

WITNESS the signature of the Applicant this the 21TH day of MAY, 2026.

Linda Taibl

By: _____
(Applicant Signature)

Title: COMCAST COORDINATOR

Note: *Applicant must be an employee of the Utility named in this application. The Madison County Board of Supervisors will not recognize a Contractor, Subcontractor, Agent, or Consulting Engineer as the Applicant. Utility Company shall be fully responsible for all work performed under this application.*

I, or my authorized representative, have reviewed this application and determined that the drawing, sketches, and plans submitted by the Applicant meet the requirements of *A Policy for The Accommodation of Utility Facilities within the Right-of-Way of all Public County Roads.*

APPROVED
By Tim Bryan at 12:10 pm, May 27, 2026

Tim Bryan, P.E.
County Engineer

AGREED TO AND APPROVED BY:

Madison County Board President

Date: _____

ENTERED INTO THE MINUTES OF THE BOARD OF SUPERVISORS OF MADISON COUNTY, MISSISSIPPI ON THIS _____ DAY OF _____, 20_____.

Appendix 1

County Road Name: OLD MAPLE COVE
Beginning Location: 32.524486,-90.134859 Ending Location 32.525542,-90.138910
Length of Project: 2208' Section: 19 Township: 8N Range: 2E

Description of Work: COMCAST INSTALL CABLE TELEVISION,INTERNET,&TELEPHONE. SEE ATTACHED PRINTS FOR EXACT LOCATIONS. INSTALL 1-2" HDPE CONDUIT

County Road Name: LEWIS FARMS DR
Beginning Location: 32.525545,-90.135933 Ending Location: 32.524708,-90.135938
Length of Project: 257' Section: 19 Township: 8N Range: 2E

Description of Work: COMCAST INSTALL CABLE TELEVISION,INTERNET,&TELEPHONE. SEE ATTACHED PRINTS FOR EXACT LOCATIONS. INSTALL 1-2" HDPE CONDUIT

County Road Name: ORCHARDVIEW COVE
Beginning Location: 32.525358,-90.137586 Ending Location: 32.525138,-90.137371
Length of Project: 456' Section: 19 Township: 8N Range: 2E

Description of Work: COMCAST INSTALL CABLE TELEVISION,INTERNET,&TELEPHONE. SEE ATTACHED PRINTS FOR EXACT LOCATIONS. INSTALL 1-2" HDPE CONDUIT

County Road Name: BERRYVILLE COURT
Beginning Location: 32.525541,-90.138668 Ending Location: 32.525138,-90.138460
Length of Project: 457' Section: 19 Township: 8N Range: 2E

Description of Work: COMCAST INSTALL CABLE TELEVISION,INTERNET,&TELEPHONE. SEE ATTACHED PRINTS FOR EXACT LOCATIONS. INSTALL 1-2" HDPE CONDUIT

County Road Name: _____
Beginning Location: _____ Ending Location: _____
Length of Project: _____ Section: _____ Township: _____ Range: _____
Description of Work: _____



COMCAST COMMUNICATIONS
 LINDA TAIBL / 404-427-1220
 5720 ASHVILLE HWY KNOXVILLE TN 37922
 linda_taibl@cable.comcast.com

WORK DESCRIPTION: 400 MAPLE COVE MADISON MS 39110
 COMCAST PROPOSES TO BORE & INSTALL 1-2" HDPE CONDUIT .625 COAX. PROJECT BEGINS FROM EXISTING PED- 32.524486,-90.134859. BORE A TOTAL OF 3378' INTO NEW PHASE OF SUBDIVISION END INSTALL NEW PEDS ALONG OLD MAPLE COVE, LEWIS FARMS DR, ORCHARDVIEW COVE AND BERRYVILLE COURT.
 TOTAL FOOTAGE: 3378'.

VICINITY MAP

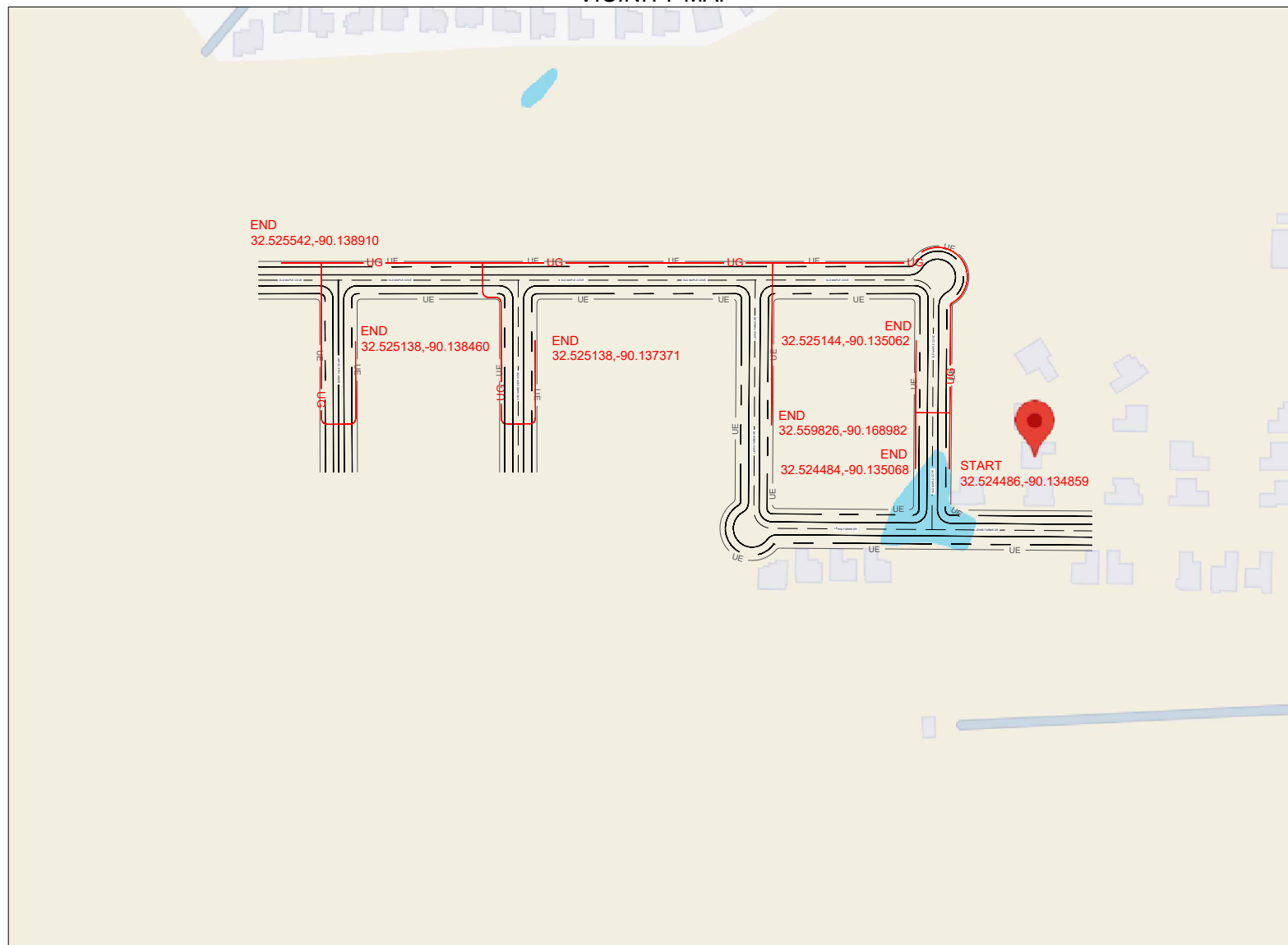

VICINITY MAP NOT TO SCALE

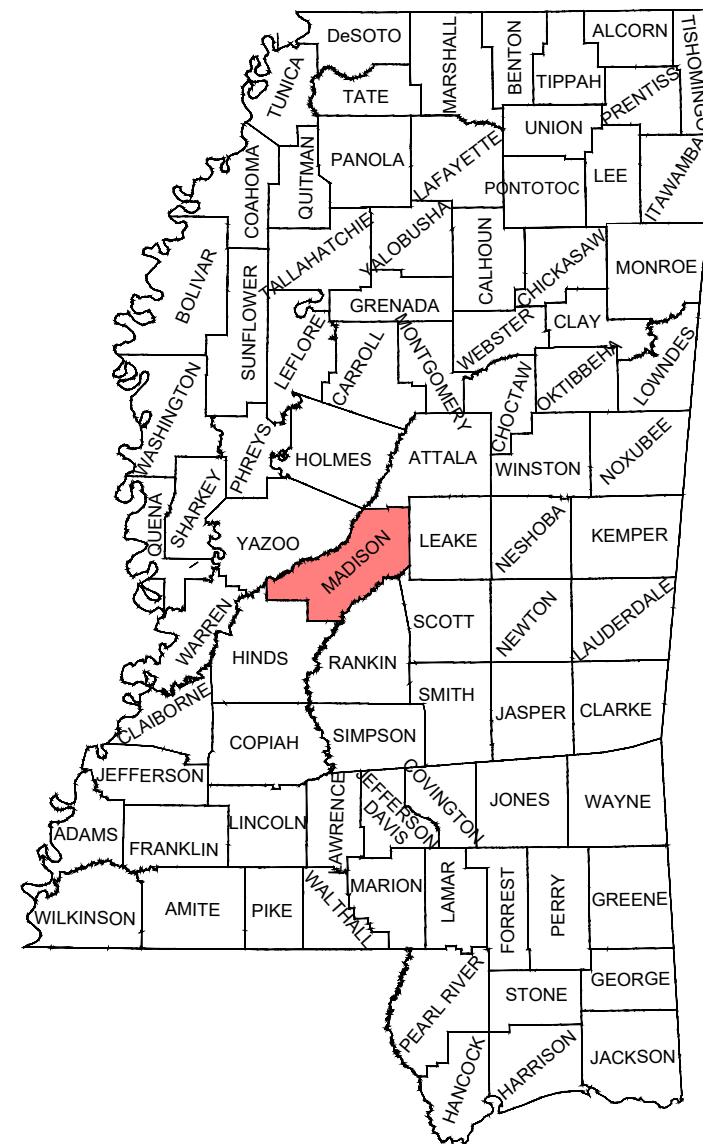

ENGINEERED BY:



ENGINEERED FOR:



LEGEND

UG	NEW UNDERGROUND
A	NEW AERIAL
EC	EXISTING CONDUIT
UE	UTILITY EASEMENT
---	EDGE OF TRAVEL
---	SURVEY CENTERLINE
---	RIGHT OF WAY
---	DRIVEWAY
X-X	FENCE LINE
PL	PROPERTY LINE
---	SIDEWALK
---	RAILROAD
W	WATER
S	SEWER
G	GAS
SD	STORM DRAIN
T	TELECO
P	POWER
UNK	UNKNOWN UTILITY

SYMBOLS

P	NEW PEDESTAL	BRIDGE RAIL
V	NEW VAULT	NEW ANCHOR
BP	NEW BORE PIT	EXT ANCHOR
P	EXT PEDESTAL	CULVERT
V	EXT VAULT	ADA RAMP
PT	EXT TRANSFORMER	PS
T	EXT TELCO	PS
SD	STORM DRAIN	RR
SI	STORM INLET	RR
TL	TRAFFIC LIGHT	SB
⊗	EXT POWER POLE	R
⊗	EXT POLE OFF R/W	R
MH	EXT MANHOLE	G
WV	WATER VAULT	G
		SD
		SD
		○
		○

ABBREVIATIONS

EOT - EDGE OF TRAVEL
 R/W - RIGHT OF WAY
 S/W - SIDEWALK
 C/L - CENTERLINE
 D/W - DRIVEWAY
 STA. - STATION NUMBER



NO SCALE

SHEET TOTALS

NEW AERIAL: 0'	NEW OVERLASH: 0'
NEW BORE: 0'	PULL EXT CONDUIT: 0'
NEW PED: 0'	NEW VAULT: 0'

PROJECT TOTALS

NEW AERIAL: 0'	NEW OVERLASH: 0'
NEW BORE: 3378'	PULL EXT CONDUIT: 0'
NEW PED: 25'	NEW VAULT: 0'

JOB #: JB0002614787
 PROJECT NAME
 MSMAMC400-UG-MADISON CO-MS
 ADDRESS, CITY, STATE, ZIP
 400 MAPLE COVE MADISON, MS 39110
 COUNTY: MADISON

ENGINEERED BY:



ENGINEERED FOR:



LEGEND

	NEW UNDERGROUND
	NEW AERIAL
	NEW AERIAL OFF R/W
	EXISTING CONDUIT
	UTILITY EASEMENT
	EDGE OF TRAVEL
	SURVEY CENTERLINE
	RIGHT OF WAY
	DRIVEWAY
	FENCE LINE
	PROPERTY LINE
	SIDEWALK
	RAILROAD
	WATER
	SEWER
	GAS
	STORM DRAIN
	TELECO
	POWER
	UNKNOWN UTILITY

SYMBOLS

	NEW PEDESTAL		BRIDGE RAIL
	NEW VAULT		NEW ANCHOR
	NEW BORE PIT		EXT ANCHOR
	EXT PEDESTAL		CULVERT
	EXT VAULT		ADA RAMP
	EXT TRANSFORMER		POWER SUPPLY
	EXT TELCO		RAILROAD SIGNAL BOX
	STORM DRAIN		RISER
	STORM INLET		GAS MARKER
	TRAFFIC LIGHT		STORM DRAIN
	EXT POWER POLE		FIRE HYDRANT
	EXT POLE OFF R/W		
	EXT MANHOLE		
	WATER VAULT		

ABBREVIATIONS

EOT - EDGE OF TRAVEL
R/W - RIGHT OF WAY
S/W - SIDEWALK
C/L - CENTERLINE
D/W - DRIVEWAY
STA. - STATION NUMBER



NO SCALE

SHEET TOTALS

NEW AERIAL: 0'	NEW OVERLASH: 0'
NEW BORE: 0'	PULL EXT CONDUIT: 0'
NEW PED: 0'	NEW VAULT: 0'

PROJECT TOTALS

NEW AERIAL: 0'	NEW OVERLASH: 0'
NEW BORE: 3378'	PULL EXT CONDUIT: 0'
NEW PED: 25'	NEW VAULT: 0'

JOB #: JB0002614787

PROJECT NAME

MSMAMC400-UG-MADISON CO-MS

ADDRESS, CITY, STATE, ZIP

400 MAPLE COVE MADISON, MS 39110

COUNTY: MADISON

SHEET 2 OF 7

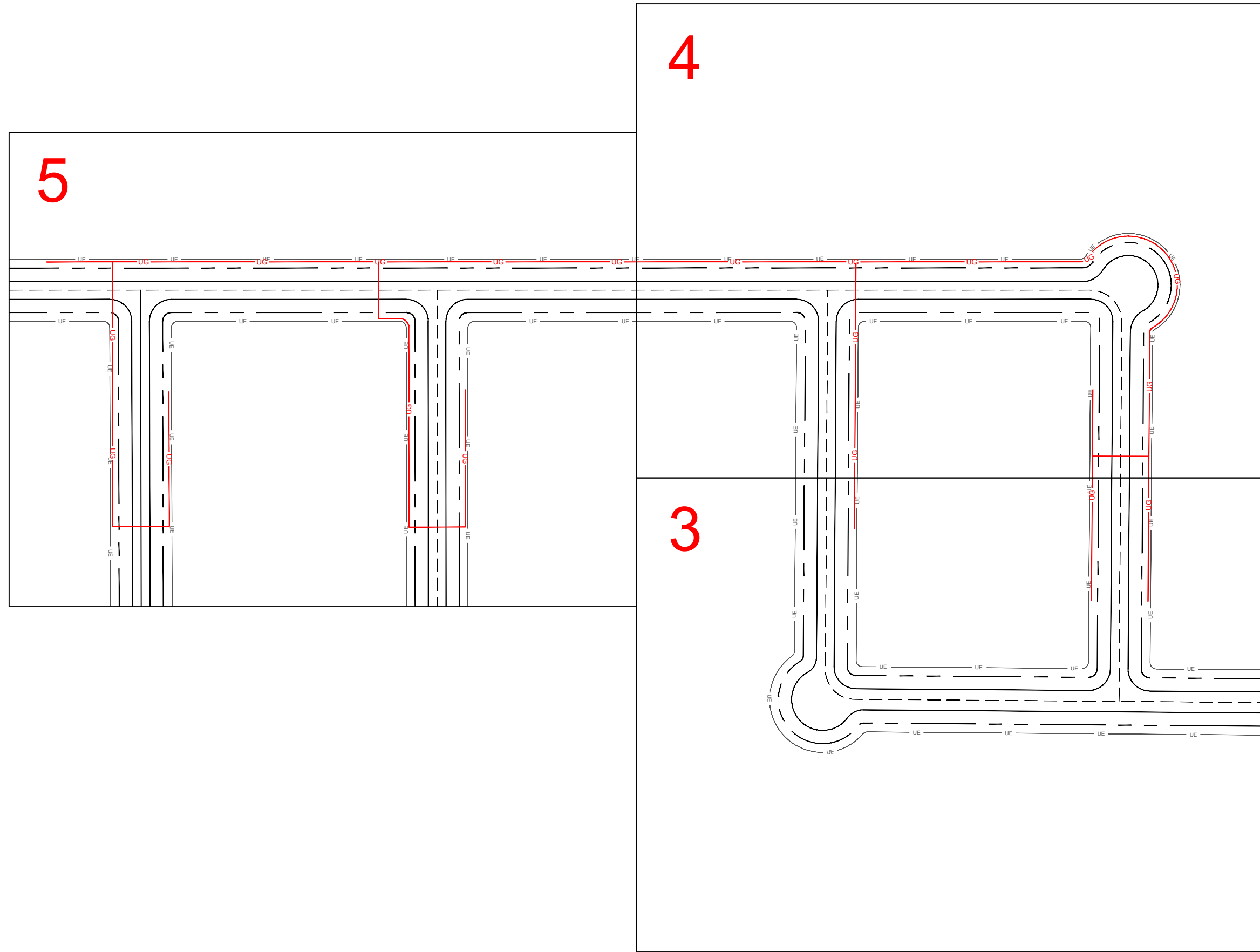

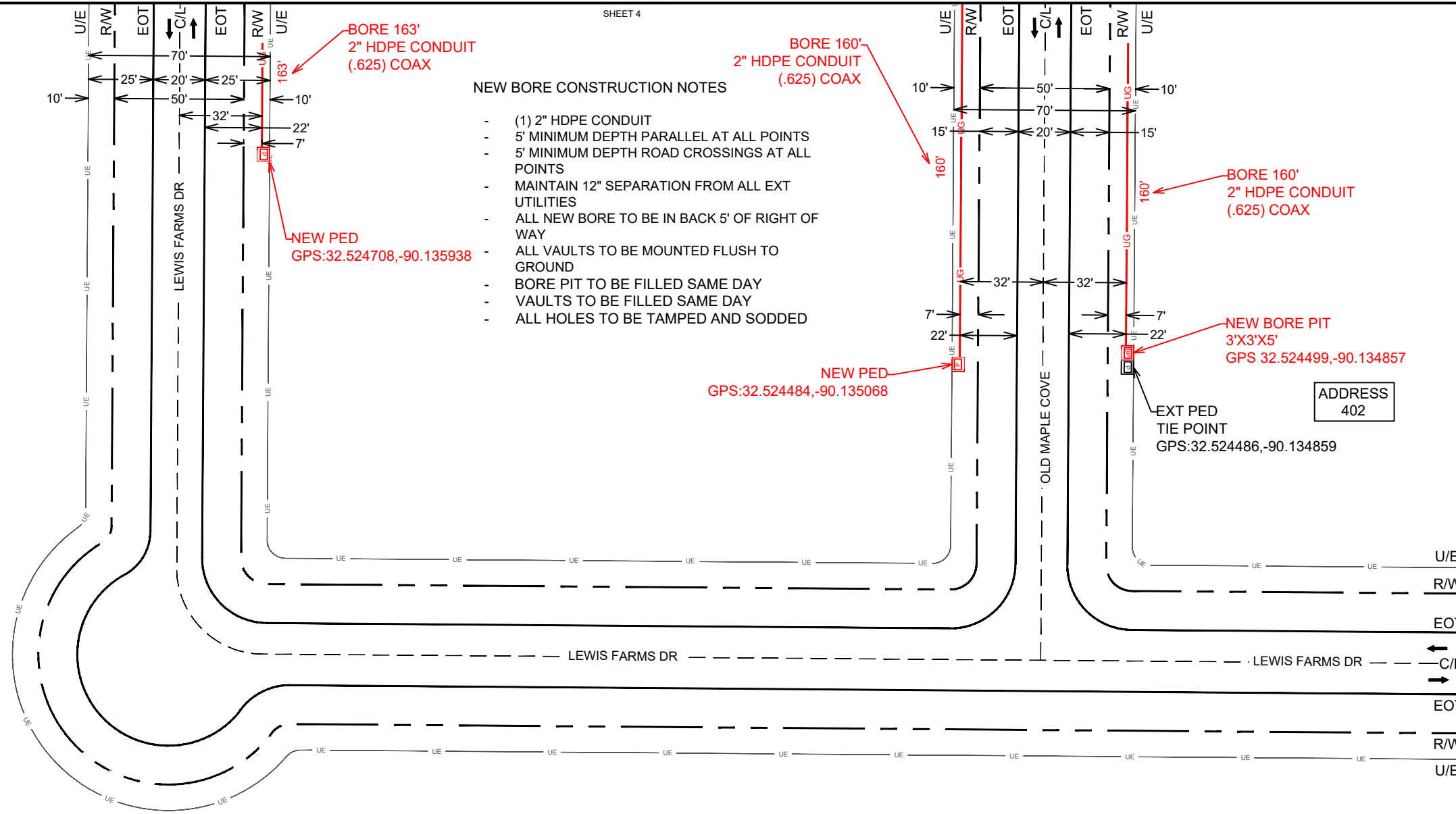

NEW BORE CONSTRUCTION NOTES

- (1) 2" HDPE CONDUIT
- 5' MINIMUM DEPTH PARALLEL AT ALL POINTS
- 5' MINIMUM DEPTH ROAD CROSSINGS AT ALL POINTS
- MAINTAIN 12" SEPARATION FROM ALL EXT UTILITIES
- ALL NEW BORE TO BE IN BACK 5' OF RIGHT OF WAY
- ALL VAULTS TO BE MOUNTED FLUSH TO GROUND
- BORE PIT TO BE FILLED SAME DAY
- VAULTS TO BE FILLED SAME DAY
- ALL HOLES TO BE TAMPED AND SODDED

ENGINEERED BY:



ENGINEERED FOR:



LEGEND

UG	NEW UNDERGROUND
A	NEW AERIAL
A	NEW AERIAL OFF R/W
EC	EXISTING CONDUIT
UE	UTILITY EASEMENT
- - -	EDGE OF TRAVEL
- - -	SURVEY CENTERLINE
- - -	RIGHT OF WAY
- - -	DRIVEWAY
- x - x -	FENCE LINE
- PL -	PROPERTY LINE
- - -	SIDEWALK
	RAILROAD
W	WATER
S	SEWER
G	GAS
SD	STORM DRAIN
T	TELECO
P	POWER
UNK	UNKNOWN UTILITY

SYMBOLS

[P]	NEW PEDESTAL	[BR]	BRIDGE RAIL
[V]	NEW VAULT	[AN]	NEW ANCHOR
[BP]	NEW BORE PIT	[EA]	EXT ANCHOR
[P]	EXT PEDESTAL	[CU]	CULVERT
[V]	EXT VAULT	[AR]	ADA RAMP
[PT]	EXT TRANSFORMER	[PS]	POWER SUPPLY
[T]	EXT TELCO	[RR]	RAILROAD SIGNAL BOX
[SD]	STORM DRAIN	[R]	RISER
[SI]	STORM INLET	[G]	GAS MARKER
[TL]	TRAFFIC LIGHT	[SD]	STORM DRAIN
[X]	EXT POWER POLE	[FH]	FIRE HYDRANT
[X]	EXT POLE OFF R/W		
[MH]	EXT MANHOLE		
[WV]	WATER VAULT		

ABBREVIATIONS

EOT - EDGE OF TRAVEL
 R/W - RIGHT OF WAY
 S/W - SIDEWALK
 C/L - CENTERLINE
 D/W - DRIVEWAY
 STA. - STATION NUMBER



NO SCALE

SHEET TOTALS

NEW AERIAL: 0'	NEW OVERLASH: 0'
NEW BORE: 483'	PULL EXT CONDUIT: 0'
NEW PED: 2'	NEW VAULT: 0'

PROJECT TOTALS

NEW AERIAL: 0'	NEW OVERLASH: 0'
NEW BORE: 3378'	PULL EXT CONDUIT: 0'
NEW PED: 25'	NEW VAULT: 0'

JOB #: JB0002614787

PROJECT NAME
 MSMAMC400-UG-MADISON CO-MS

ADDRESS, CITY, STATE, ZIP
 400 MAPLE COVE MADISON, MS 39110

COUNTY: MADISON

ENGINEERED BY:



ENGINEERED FOR:



LEGEND

UG	NEW UNDERGROUND
A	NEW AERIAL
A	NEW AERIAL OFF R/W
EC	EXISTING CONDUIT
UE	UTILITY EASEMENT
---	EDGE OF TRAVEL
---	RIGHT OF WAY
---	SURVEY CENTERLINE
---	DRIVEWAY
X-X	FENCE LINE
PL	PROPERTY LINE
---	SIDEWALK
---	RAILROAD
W	WATER
S	SEWER
G	GAS
SD	STORM DRAIN
T	TELECO
P	POWER
UNK	UNKNOWN UTILITY

SYMBOLS

[P]	NEW PEDESTAL	[BR]	BRIDGE RAIL
[V]	NEW VAULT	[NA]	NEW ANCHOR
[BP]	NEW BORE PIT	[EA]	EXT ANCHOR
[P]	EXT PEDESTAL	[CU]	CULVERT
[V]	EXT VAULT	[AR]	ADA RAMP
[PT]	EXT TRANSFORMER	[PS]	POWER SUPPLY
[T]	EXT TELCO	[RR]	RAILROAD SIGNAL BOX
[SD]	STORM DRAIN	[R]	RISER
[SI]	STORM INLET	[G]	GAS MARKER
[TL]	TRAFFIC LIGHT	[SD]	STORM DRAIN
[XP]	EXT POWER POLE	[FH]	FIRE HYDRANT
[XPO]	EXT POLE OFF R/W		
[MH]	EXT MANHOLE		
[WV]	WATER VAULT		

ABBREVIATIONS

EOT - EDGE OF TRAVEL
 R/W - RIGHT OF WAY
 S/W - SIDEWALK
 C/L - CENTERLINE
 DW - DRIVEWAY
 STA. - STATION NUMBER



NO SCALE

SHEET TOTALS

NEW AERIAL: 0'	NEW OVERLASH: 0'
NEW BORE: 1277'	PULL EXT CONDUIT: 0'
NEW PED: 10'	NEW VAULT: 0'

PROJECT TOTALS

NEW AERIAL: 0'	NEW OVERLASH: 0'
NEW BORE: 3378'	PULL EXT CONDUIT: 0'
NEW PED: 25'	NEW VAULT: 0'

JOB #: JB0002614787

PROJECT NAME: MSMAMC400-UG-MADISON CO-MS

ADDRESS, CITY, STATE, ZIP: 400 MAPLE COVE MADISON, MS 39110

COUNTY: MADISON

SHEET 5

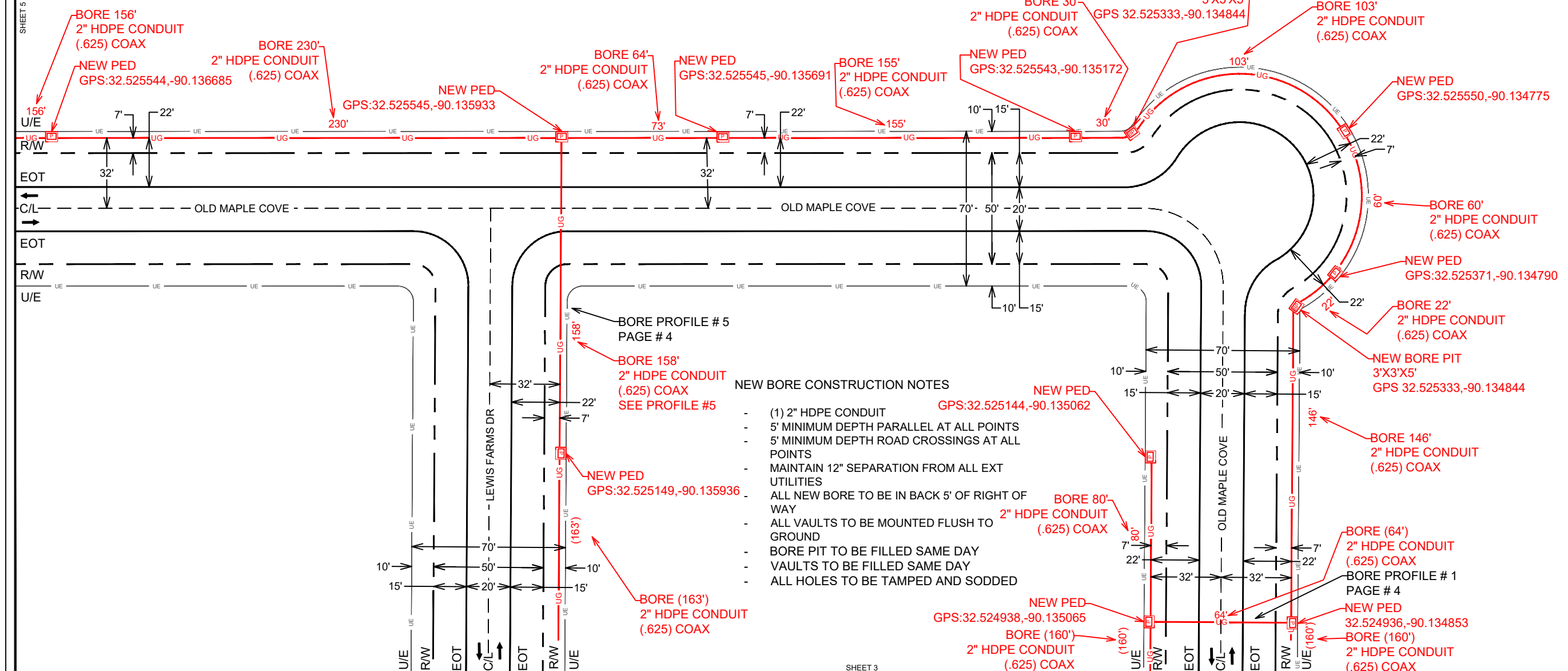

NEW BORE CONSTRUCTION NOTES

- (1) 2" HDPE CONDUIT
- 5' MINIMUM DEPTH PARALLEL AT ALL POINTS
- 5' MINIMUM DEPTH ROAD CROSSINGS AT ALL POINTS
- MAINTAIN 12" SEPARATION FROM ALL EXT UTILITIES
- ALL NEW BORE TO BE IN BACK 5' OF RIGHT OF WAY
- ALL VAULTS TO BE MOUNTED FLUSH TO GROUND
- BORE PIT TO BE FILLED SAME DAY
- VAULTS TO BE FILLED SAME DAY
- ALL HOLES TO BE TAMPED AND SODDED

ENGINEERED BY:



ENGINEERED FOR:



LEGEND

UG	NEW UNDERGROUND
A	NEW AERIAL
EA	NEW AERIAL OFF R/W
EC	EXISTING CONDUIT
UE	UTILITY EASEMENT
ET	EDGE OF TRAVEL
ES	SURVEY CENTERLINE
ES	RIGHT OF WAY
ES	DRIVEWAY
ES	FENCE LINE
PL	PROPERTY LINE
PL	SIDEWALK
RR	RAILROAD
W	WATER
S	SEWER
G	GAS
SD	STORM DRAIN
T	TELECO
P	POWER
UNK	UNKNOWN UTILITY

SYMBOLS

[P]	NEW PEDESTAL	[BR]	BRIDGE RAIL
[V]	NEW VAULT	[NA]	NEW ANCHOR
[BP]	NEW BORE PIT	[EA]	EXT ANCHOR
[EP]	EXT PEDESTAL	[CU]	CULVERT
[EV]	EXT VAULT	[AR]	ADA RAMP
[PT]	EXT TRANSFORMER	[PS]	POWER SUPPLY
[T]	EXT TELCO	[RR]	RAILROAD SIGNAL BOX
[SD]	STORM DRAIN	[R]	RISER
[SI]	STORM INLET	[G]	GAS MARKER
[TL]	TRAFFIC LIGHT	[SB]	STORM DRAIN
[XP]	EXT POWER POLE	[FH]	FIRE HYDRANT
[XPO]	EXT POLE OFF R/W		
[MH]	EXT MANHOLE		
[WV]	WATER VAULT		

ABBREVIATIONS

EOT	- EDGE OF TRAVEL
R/W	- RIGHT OF WAY
S/W	- SIDEWALK
C/L	- CENTERLINE
D/W	- DRIVEWAY
STA.	- STATION NUMBER



NO SCALE

SHEET TOTALS

NEW AERIAL:	0'	NEW OVERLASH:	0'
NEW BORE:	1618'	PULL EXT CONDUIT:	0'
NEW PED:	13'	NEW VAULT:	0'

PROJECT TOTALS

NEW AERIAL:	0'	NEW OVERLASH:	0'
NEW BORE:	3378'	PULL EXT CONDUIT:	0'
NEW PED:	25'	NEW VAULT:	0'

JOB #: JB0002614787
 PROJECT NAME: MSMAMC400-UG-MADISON CO-MS
 ADDRESS, CITY, STATE, ZIP: 400 MAPLE COVE MADISON, MS 39110
 COUNTY: MADISON

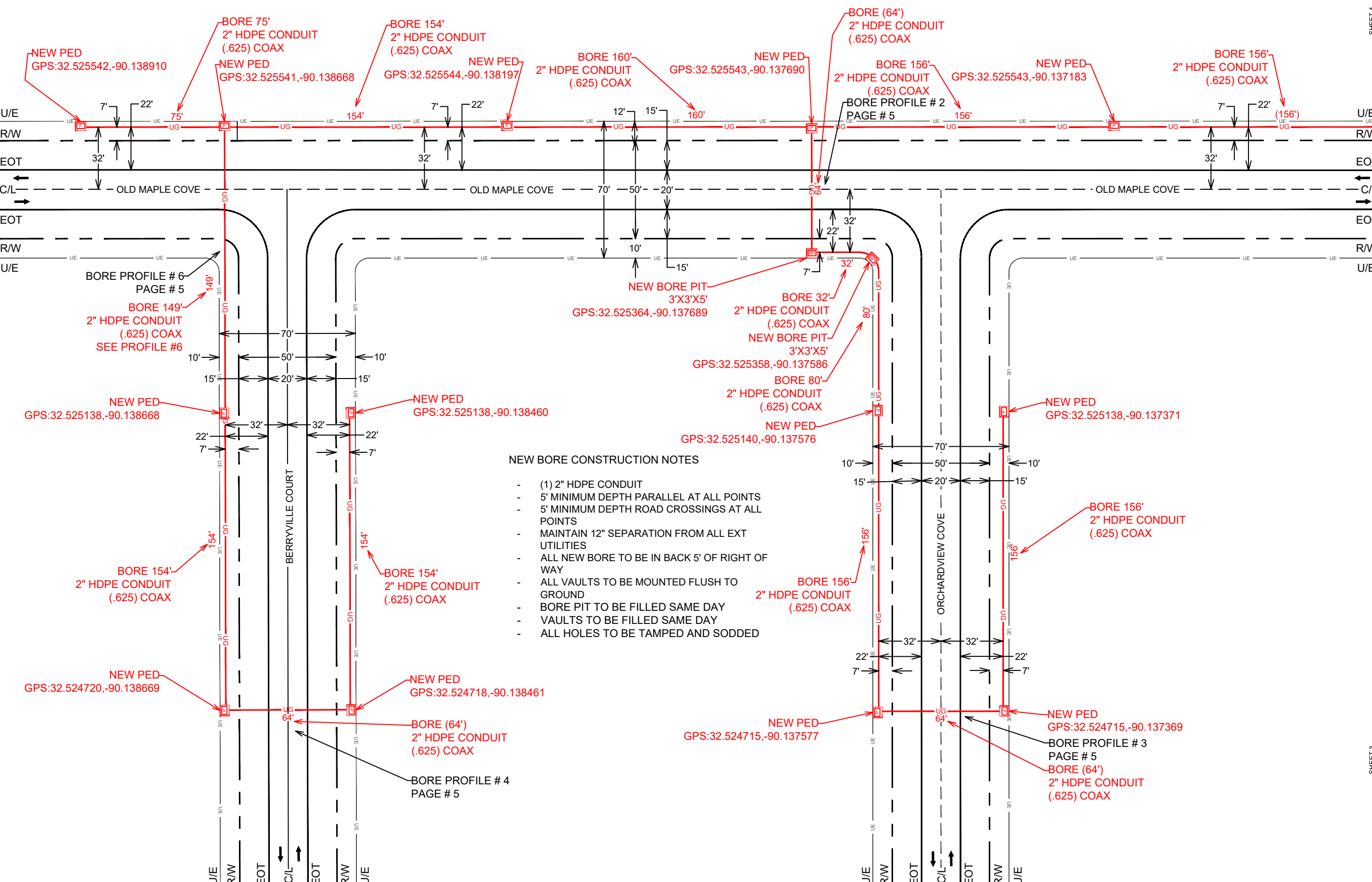

NEW BORE CONSTRUCTION NOTES

- (1) 2" HDPE CONDUIT
- 5' MINIMUM DEPTH PARALLEL AT ALL POINTS
- 5' MINIMUM DEPTH ROAD CROSSINGS AT ALL POINTS
- MAINTAIN 12" SEPARATION FROM ALL EXT UTILITIES
- ALL NEW BORE TO BE IN BACK 5' OF RIGHT OF WAY
- ALL VAULTS TO BE MOUNTED FLUSH TO GROUND
- BORE PIT TO BE FILLED SAME DAY
- VAULTS TO BE FILLED SAME DAY
- ALL HOLES TO BE TAMPED AND SODDED

SHEET 4

SHEET 3

BORE PROFILE #1
PAGE #4
STREET NAME: OLD MAPLE COVE
FACING NORTH

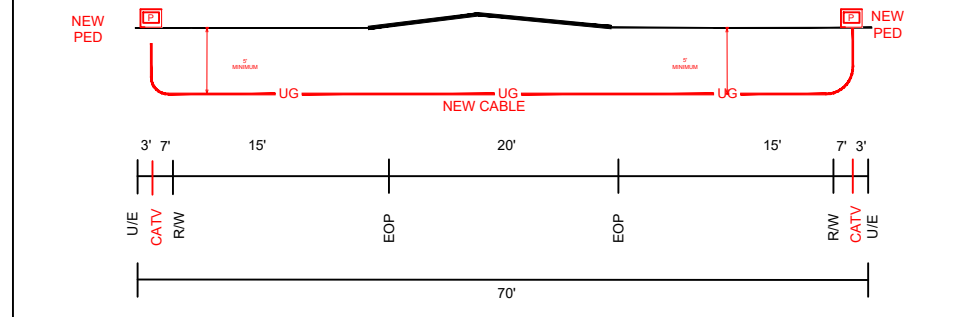

BORE PROFILE #2
PAGE #5
STREET NAME: OLD MAPLE COVE
FACING EAST

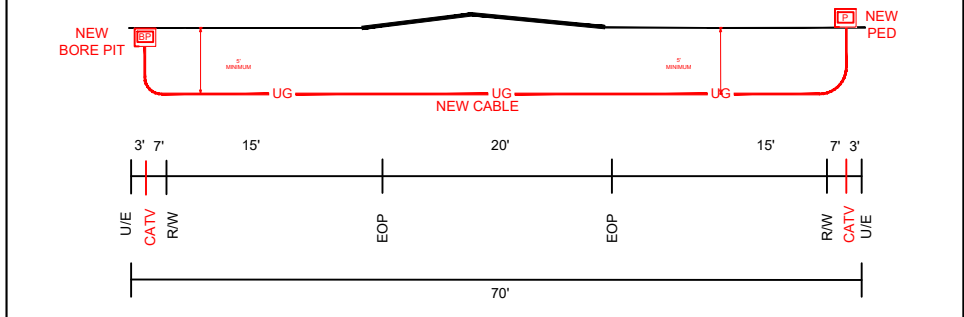

BORE PROFILE #3
PAGE #5
STREET NAME: ORCHARDVIEW COVE
FACING NORTH

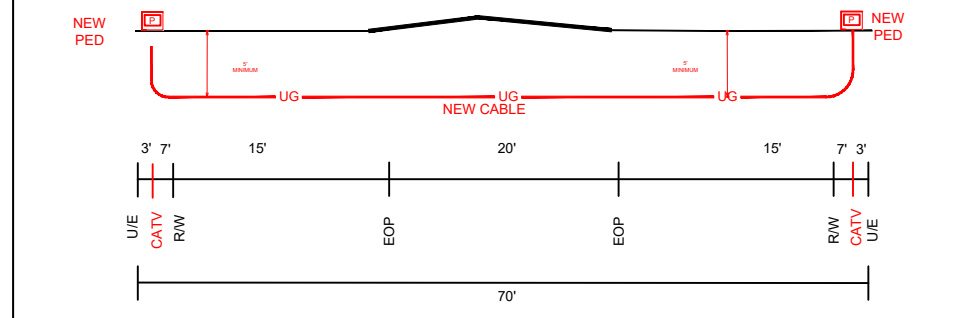

BORE PROFILE #4
PAGE #5
STREET NAME: BERRYVILLE COURT
FACING NORTH

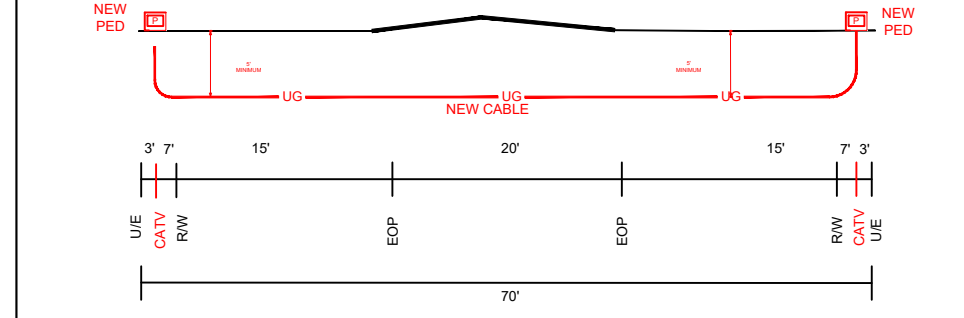

ENGINEERED BY:



ENGINEERED FOR:



LEGEND

	UG	NEW UNDERGROUND
	A	NEW AERIAL
	A	NEW AERIAL OFF R/W
	EC	EXISTING CONDUIT
	UE	UTILITY EASEMENT
		EDGE OF TRAVEL
		SURVEY CENTERLINE
		RIGHT OF WAY
		DRIVEWAY
		FENCE LINE
		PROPERTY LINE
		SIDEWALK
		RAILROAD
	W	WATER
	S	SEWER
	G	GAS
	SD	STORM DRAIN
	T	TELECO
	P	POWER
	UNK	UNKNOWN UTILITY

SYMBOLS

	NEW PEDESTAL		BRIDGE RAIL
	NEW VAULT		NEW ANCHOR
	NEW BORE PIT		EXT ANCHOR
	EXT PEDESTAL		CULVERT
	EXT VAULT		ADA RAMP
	EXT TRANSFORMER		POWER SUPPLY
	EXT TELCO		RAILROAD SIGNAL BOX
	STORM DRAIN		RISER
	STORM INLET		GAS MARKER
	TRAFFIC LIGHT		STORM DRAIN
	EXT POWER POLE		FIRE HYDRANT
	EXT POLE OFF R/W		
	EXT MANHOLE		
	WATER VAULT		

ABBREVIATIONS

EOT - EDGE OF TRAVEL	
R/W - RIGHT OF WAY	
S/W - SIDEWALK	
C/L - CENTERLINE	
D/W - DRIVEWAY	
STA. - STATION NUMBER	

NO SCALE

SHEET TOTALS

NEW AERIAL: 0'	NEW OVERLASH: 0'
NEW BORE: 0'	PULL EXT CONDUIT: 0'
NEW PED: 0'	NEW VAULT: 0'

PROJECT TOTALS

NEW AERIAL: 0'	NEW OVERLASH: 0'
NEW BORE: 3378'	PULL EXT CONDUIT: 0'
NEW PED: 25'	NEW VAULT: 0'

JOB #: JB0002614787
PROJECT NAME: MSMAMC400-UG-MADISON CO-MS
ADDRESS, CITY, STATE, ZIP: 400 MAPLE COVE MADISON, MS 39110
COUNTY: MADISON

BORE PROFILE #5
PAGE #4
STREET NAME: ORCHARDVIEW COVE
FACING EAST

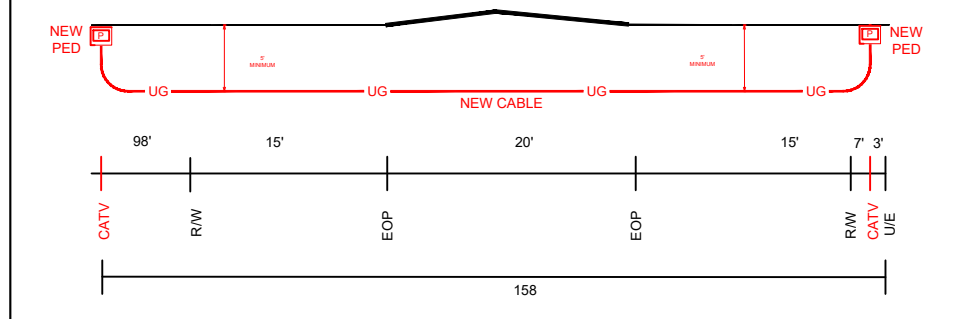

BORE PROFILE #6
PAGE #5
STREET NAME: OLD MAPLE COVE
FACING EAST

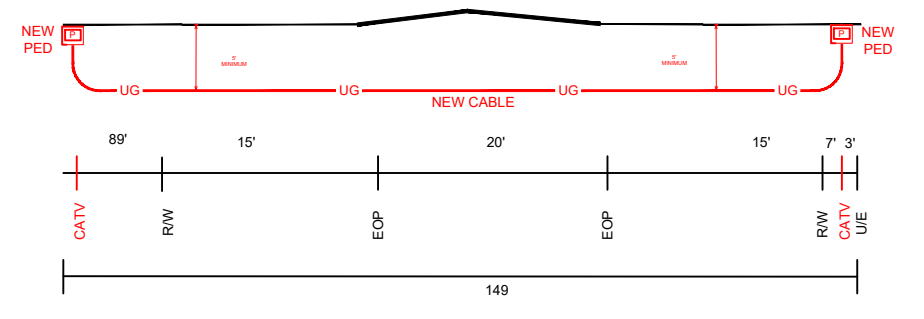

ENGINEERED BY:



ENGINEERED FOR:



LEGEND

	UG	NEW UNDERGROUND
	A	NEW AERIAL
	A	NEW AERIAL OFF R/W
	EC	EXISTING CONDUIT
	UE	UTILITY EASEMENT
	EOT	EDGE OF TRAVEL
	S/W	RIGHT OF WAY
	C/L	SURVEY CENTERLINE
	D/W	DRIVEWAY
	X	FENCE LINE
	PL	PROPERTY LINE
	S/W	SIDEWALK
	RR	RAILROAD
	W	WATER
	S	SEWER
	G	GAS
	SD	STORM DRAIN
	T	TELECO
	P	POWER
	UNK	UNKNOWN UTILITY

SYMBOLS

	NEW PEDESTAL		BRIDGE RAIL
	NEW VAULT		NEW ANCHOR
	NEW BORE PIT		EXT ANCHOR
	EXT PEDESTAL		CULVERT
	EXT VAULT		ADA RAMP
	EXT TRANSFORMER		POWER SUPPLY
	EXT TELCO		RAILROAD SIGNAL BOX
	STORM DRAIN		RISER
	STORM INLET		GAS MARKER
	TRAFFIC LIGHT		STORM DRAIN
	EXT POWER POLE		FIRE HYDRANT
	EXT POLE OFF R/W		
	EXT MANHOLE		
	WATER VAULT		

ABBREVIATIONS

EOT - EDGE OF TRAVEL
R/W - RIGHT OF WAY
S/W - SIDEWALK
C/L - CENTERLINE
D/W - DRIVEWAY
STA. - STATION NUMBER



NO SCALE

SHEET TOTALS

NEW AERIAL: 0'	NEW OVERLASH: 0'
NEW BORE: 0'	PULL EXT CONDUIT: 0'
NEW PED: 0'	NEW VAULT: 0'

PROJECT TOTALS

NEW AERIAL: 0'	NEW OVERLASH: 0'
NEW BORE: 3378'	PULL EXT CONDUIT: 0'
NEW PED: 25'	NEW VAULT: 0'

JOB #: JB0002614787

PROJECT NAME

MSMAMC400-UG-MADISON CO-MS

ADDRESS, CITY, STATE, ZIP

400 MAPLE COVE MADISON, MS 39110

COUNTY: MADISON

SHEET 7 OF 7